

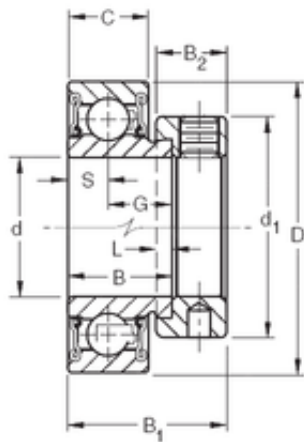

American Precision Parts Co., Ltd.



25,4 mm x 52 mm x 21,44 mm TIMKEN RA100RR Insert Bearings Cylindrical OD

Bearing No. RA100RR

Size	25.4x52x21.44 mm
Bore Diameter	25,4 mm
Outer Diameter	52 mm
Width	21,44 mm
d	25,4 mm
D	52 mm
B	21,44 mm
C	15 mm
d1	38,1 mm
B1	31 mm
B2	13,5 mm
G	13,92 mm
L	4 mm
S	7,49 mm
Weight	0,186 Kg
Basic dynamic load rating (C)	15,8 kN

RA100RR Bearing 2D drawings and 3D CAD models